

# HILTON PORTLAND & EXECUTIVE TOWER

## THE FACTS



Impeccable service, beautiful surroundings and a warm sense of welcome make Hilton Portland & Executive Tower the ideal choice for business and leisure travelers alike. Set in the heart of Portland's business and entertainment district, it is the city's largest green hotel, combining comfort with environmental responsibility. The two-building complex offers premium amenities and puts Guests within easy reach of shopping, dining and many other exciting attractions.

### AT A GLANCE

- 782 beautifully appointed, non-smoking guest rooms
- Conveniently located in the heart of Downtown Portland
- Just 2 short blocks from public transportation
- A total of 72,000ft<sup>2</sup> of meeting space including 32 function rooms and an Exhibit Hall
- On-site UPS Store offering a full range of services
- 12,000ft<sup>2</sup> state-of-the-art Athletic Club
- Each tower features its own meeting space, parking, gift shop, fitness center and restaurants



## MEETINGS & EVENTS

With 72,000ft<sup>2</sup> of flexible meeting and exhibit space, Hilton Portland and Executive Tower makes the perfect place to host events of all types and sizes. The contemporary elegance of our meeting and banquet rooms creates an inviting atmosphere for event attendees. Our friendly and highly trained team sees to every detail, offering personalized attention to make sure your event runs seamlessly. Scrumptious food from our highly acclaimed Banquet Department makes any gathering more special.

- Meeting rooms
- Business Center
- Audio/visual equipment rental
- Conference phone service
- Photocopying services
- Videoconferencing, videophone, video messaging
- Fax, modem, printer
- Office rental
- Express mail

## OUT & ABOUT

Nature lovers have come to the right place. Take a day trip to stunning Mount Hood and enjoy biking, hiking, skiing, snowboarding and more. The Columbia River Gorge is beautiful year round, the ideal place to go whitewater rafting, kayaking and windsurfing. Just a few blocks from the hotel, you'll find several parks where you can picnic, visit the Farmer's Market or simply relax. Stroll along the waterfront and explore the variety of events held there.



## OUR ROOMS

### GUEST ROOMS

Settle into comfort in one of our inviting guest rooms. The Hilton Serenity Bed™ is designed for a good night's rest with down duvet and rich linens. If you need to work, there's a large desk, high speed wireless internet access and dual-line phones with personalized voicemail and data ports. If you just want to relax, enjoy the 37-inch HDTV offering movies, video games and complimentary HBO. Other conveniences include: complimentary coffee and tea, stylish bath amenities, alarm clock, hairdryer, iron and ironing board.

### SUITES

Add an extra note of luxury to your stay in Portland with a one-bedroom or two-bedroom suite. These spacious retreats feature chic furnishings, living area, dining area and two full baths. The corner location on a high floor gives you spectacular city views.

### EXECUTIVE ROOMS

Our Executive Tower guest rooms and suites come with all the standard amenities and so much more: extra space, refined furnishings, complimentary bottled water and plush robes. With stunning views, these rooms create an oasis for the senses.

Accessible rooms are available.

## LOCATION

Located in the heart of the city's vibrant downtown, Hilton Portland and Executive Tower is only 25 minutes from the airport and a block from Pioneer Courthouse Square. Catch public transportation just a quick block away, putting all of Portland within easy reach.

**HILTON PORTLAND & EXECUTIVE TOWER**  
921 SW Sixth Avenue | Portland, OR 97204

T: +1 503 226 1611  
F: +1 503 220 2565  
E: [pdxph-salesadm@hilton.com](mailto:pdxph-salesadm@hilton.com)

[portland.hilton.com](http://portland.hilton.com)

## SUSTAINABILITY

Hilton Portland and Executive Tower is certified by Green Seal, a non-profit organization that promotes sustainability. Here are some of our green-friendly efforts:

- **Energy Improvements** — Including compact fluorescent light bulbs and motion-sensor thermostats in all guest rooms
- **Water Conservation** — Low-flow toilets and showerheads, smaller basins and linen and towel reuse program
- **Recycling and Composting** — From repurposing used toiletries and old furnishings to composting food waste
- **Waste Minimization** — Including double-sided printing on our copy machines, automatic paper towel dispensers in public restrooms and bath product dispensers instead of individual bottles in our Athletic Club
- **Products and Services** — Preference given to green suppliers
- **Green Conferences** — A variety of measures to make our conferences and events more eco-friendly

This is just the beginning! We continue to look for ways to make our operations even greener.



## EAT & DRINK

### BISTRO 921

Stop in for a delicious breakfast, lunch or dinner in a fun and laid-back atmosphere. This is the ideal spot to meet friends for a meal or grab a snack on the run.

### BISTRO 921 BAR

Catch your favorite sports teams in action on 3 big-screen high def TVs while enjoying a local microbrew, wine or cocktail. Stop in for happy hour Monday through Friday, 3:30pm until 6:00pm and 9:00pm until close.

### PORTO TERRA TUSCAN GRILL AND BAR

Delight in Northern Italian cuisine created from the finest local ingredients. Porto Terra's eclectic menu features pasta, pizza and entrées, and changes daily so there's always something new to try.

### IN-ROOM DINING

You don't need to go out to have a good time. Indulge in a mouthwatering meal in the comfort of your own room and enjoy superior service.

# FLOOR PLAN FOR CONFERENCE & EVENT ROOMS

## FLOOR MAPS

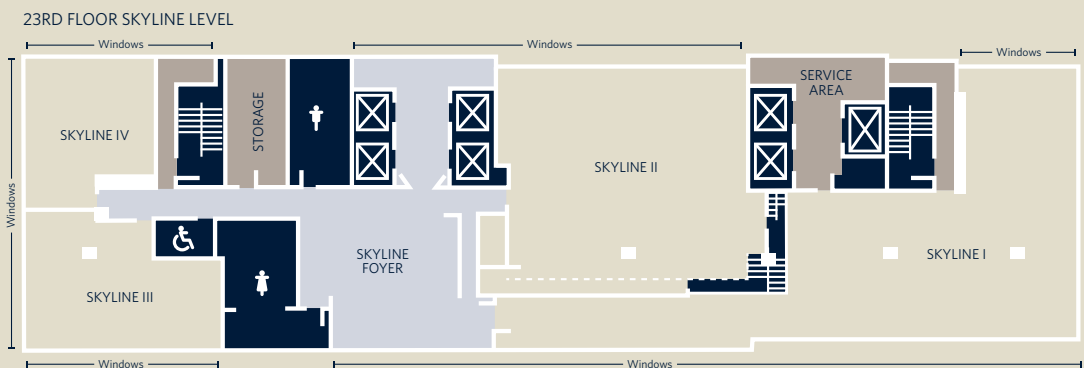
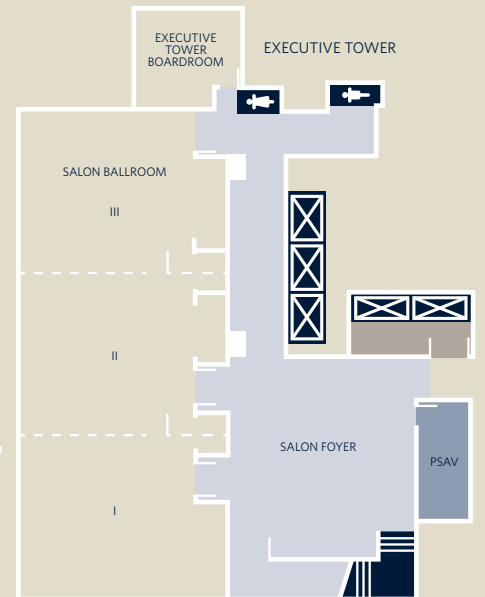
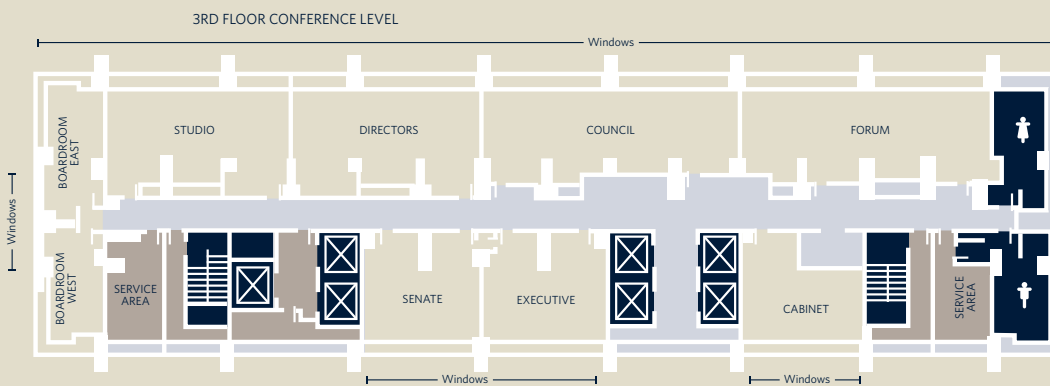

## KEY

-  Elevators
-  Meeting/Conference Rooms
-  Service Area
-  Amenities
-  Foyer Space

# CAPACITY CHART

## FOR CONFERENCE & EVENT ROOMS

### CAPACITIES & DIMENSIONS

	L x W x H	Square Feet	Theater	Classroom (3 per 6)	Conference	Banquet (Rounds of 10)	Reception	U-Shape	Hollow Square	Exhibits (8 x 10)
<b>BALLROOM LEVEL</b>										
Grand Ballroom	147 x 87 x 18'	12,657	1,150	650		1,070	1,500			70
I	78 x 87 x 18'	6,786	560	320		550	780			36
II	47 x 87 x 18'	4,089	350	200		320	470			24
GBR I/II	125 x 87 x 18'	10,875	950	575		870	1,250			62
Ballroom Foyer	123 x 26 x 9'	3,198					300			18
Parlor A+B+C	22 x 81 x 9'8"	1,782	180	112		140	135			12
Parlors A/B/C (ea)	22 x 27 x 9'8"	594	50	30	20	40	50	20	26	
Galleria	98 x 38 x 9'7"	3,724	300	140		300	320			20
Galleria North	48 x 38 x 9'7"	1,824	175	70	44	150	160	39	48	9
Galleria South	48 x 38 x 9'7"	1,824	175	70	44	150	160	39	48	9
I	33 x 38 x 9'7"	1,254	75	35	22	60	90			
II	36 x 38 x 9'7"	1,368	120	60	34	100	110			
III	29 x 38 x 9'7"	1,102	75	35	22	60	90			
<b>PLAZA LEVEL</b>										
Pavilion	84 x 84 x 16'9"	6,520	600	280		480	600	100	120	28
Pavilion East	44 x 84 x 16'9"	3,365	250	110	75	230	300	60	80	
Pavilion West	42 x 84 x 16'9"	3,106	250	110	75	210	250	60	80	
Broadway	104 x 26 x 10'	2,706	260	130	60	220	260	60	90	14
I/II/III/IV (ea)	26 x 26 x 10'	676	65	35	24	50	30	24	30	
Plaza Foyer		4,000					320			26
Plaza Suite	31 x 16 x 8'6"	496	30	24	18			24	26	
<b>3RD FLOOR CONFERENCE LEVEL</b>										
Forum Suite	48 x 15 x 8'6"	720	70	48	36	50	70	34	37	
Council Suite	49 x 15 x 8'6"	735	70	48	36	50	70	34	37	
Directors Suite	36 x 15 x 8'6"	540	48	36	24	40	50	22	25	
Studio Suite	36 x 15 x 8'6"	540	48	36	24	40	50	22	25	
Executive Suite	23 x 15 x 8'6"	345	30	18	18	30	30	18	21	
Senate Suite	23 x 15 x 8'6"	345	30	18	18	30	30	18	21	
Cabinet Suite	23 x 8 x 8'6"	260	20	12	12	20	20	15		
Boardroom East	19 x 11 x 8'6"	209			10	10				
Boardroom West	22 x 11 x 8'6"	242			10	10				
<b>23RD FLOOR SKYLINE LEVEL</b>										
Skyline I	60 x 47 x 10'	1680	85	68	50	140	175	48	46	10
Skyline II	44 x 36 x 9'	1800	185	75	44	180	200	50	64	10
Skyline III	35 x 21 x 10'	510	50	35	34	50	50	32	36	
Skyline IV	23 x 19 x 10'	330	40	28	20	30	30	18	26	
<b>EXECUTIVE TOWER</b>										
Boardroom	20 x 17 x 9'6"	400			12					
Salon Ballroom	75 x 28 x 12'	2,100	230	120		180	250			14
Salon Ballroom I/II/III (ea)	25 x 28 x 12'	700	70	40	25	50	70	25	40	6
Salon Ballroom I/II	50 x 28 x 12'	1,480	140	80	50	130	140	44	80	9
Salon Foyer	29 x 30 x 12'	870					60			

